



# MX Street Clara



## Advantages

- ceramic LEDs, corrosion resistant
- a dozen types of lenses allowing optimum light distribution
- tool-free opening of the luminaire
- pressure compensation valve
- control possible in DALI, DIM 1-10V, Virtual Extension, PLC



### LED 2.0 I

Product code	P	Im	K	Ra	IP	Beam angle	Weight
CD2-I-WW-ENC	26	3200	3000K	>70	66	30°x120°, 45°x150°, 70°x120°, PD	7,0 kg
CD2-I-NW-ENC	24	3300	4000K	>70	66	30°x120°, 45°x150°, 70°x120°, PD	7,0 kg
CD2-I-CW-ENC	24	3300	5700K	>70	66	30°x120°, 45°x150°, 70°x120°, PD	7,0 kg

### LED 2.0 II

Product code	P	Im	K	Ra	IP	Beam angle	Weight
CD2-II-WW-ENC	44	5300	3000K	>70	66	30°x120°, 45°x150°, 70°x120°, PD	7,0 kg
CD2-II-NW-ENC	40	5500	4000K	>70	66	30°x120°, 45°x150°, 70°x120°, PD	7,0 kg
CD2-II-CW-ENC	40	5550	5700K	>70	66	30°x120°, 45°x150°, 70°x120°, PD	7,0 kg

### LED 2.0 III

Product code	P	Im	K	Ra	IP	Beam angle	Weight
CD2-III-WW-ENC	52	6400	3000K	>70	66	30°x120°, 45°x150°, 70°x120°, PD	7,0 kg
CD2-III-NW-ENC	48	6600	4000K	>70	66	30°x120°, 45°x150°, 70°x120°, PD	7,0 kg
CD2-III-CW-ENC	48	6600	5700K	>70	66	30°x120°, 45°x150°, 70°x120°, PD	7,0 kg

### LED 2.0 IV

Product code	P	lm	K	Ra	IP	△	kg
CD2-IV-WW-ENC	77	9600	3000K	>70	66	30°x120°, 45°x150°, 70°x120°, PD	7,2 kg
CD2-IV-NW-ENC	72	9900	4000K	>70	66	30°x120°, 45°x150°, 70°x120°, PD	7,2 kg
CD2-IV-CW-ENC	72	9900	5700K	>70	66	30°x120°, 45°x150°, 70°x120°, PD	7,2 kg

### LED 2.0V

Product code	P	lm	K	Ra	IP	△	kg
CD2-V-WW-ENC	94	11950	3000K	>70	66	30°x120°, 45°x150°, 70°x120°, PD	7,2 kg
CD2-V-NW-ENC	94	13150	4000K	>70	66	30°x120°, 45°x150°, 70°x120°, PD	7,2 kg
CD2-V-CW-ENC	94	13150	5700K	>70	66	30°x120°, 45°x150°, 70°x120°, PD	7,2 kg

## Dimensions

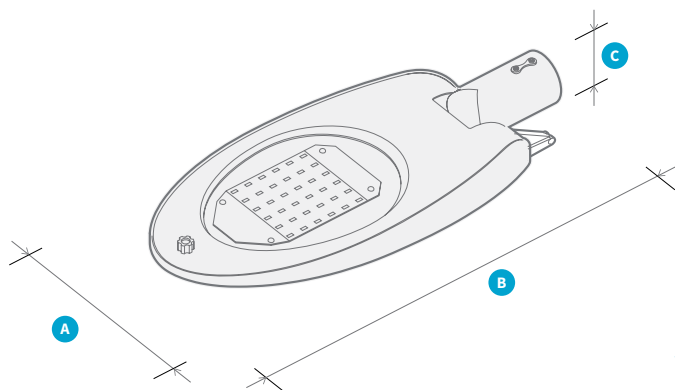

Product code	A	B	C
CD2-ENC	295	620	152

Shipping quantity			Pallet size 1 - 120x80
CD2-ENC	3	27 <sup>1</sup>	

## Mounting

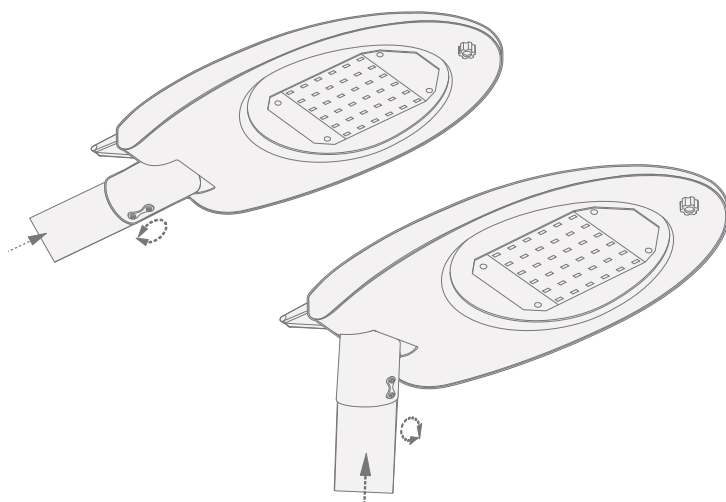

pole mounted

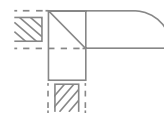

# Luminous Intensity Distribution

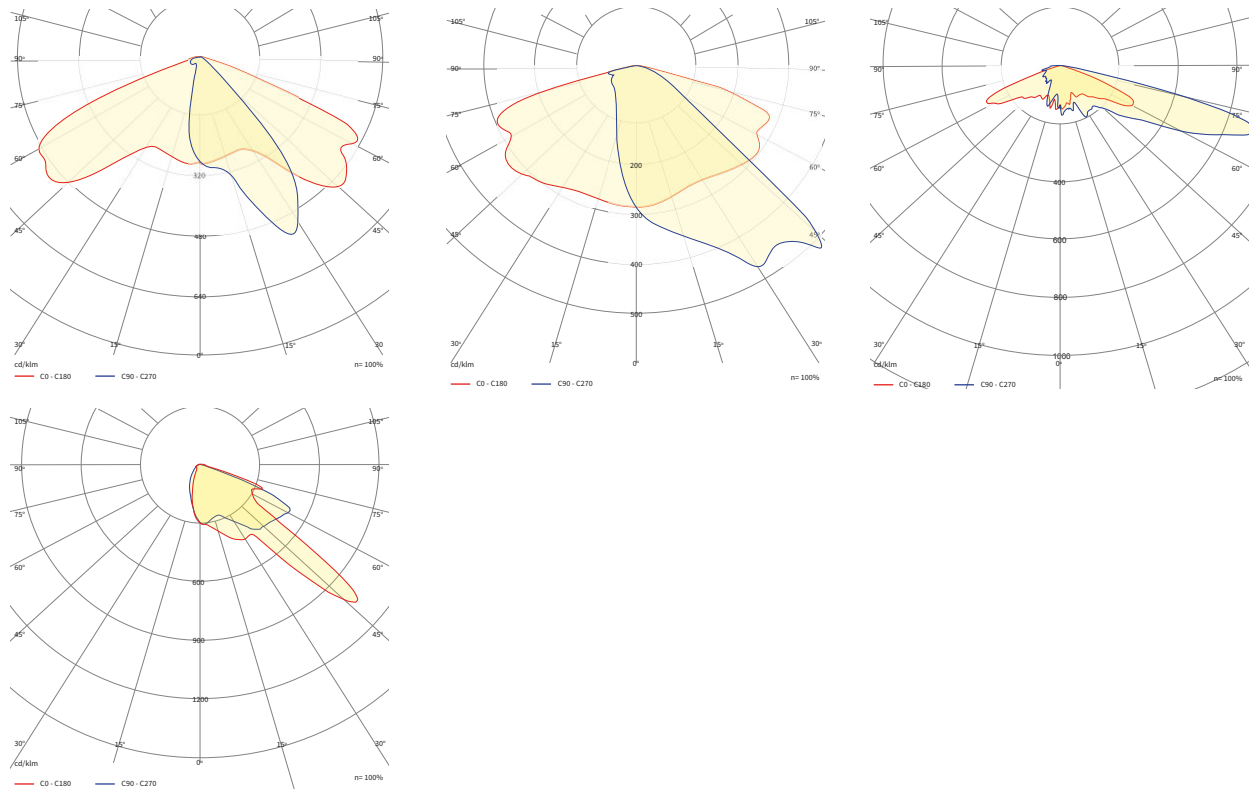

Available configurations

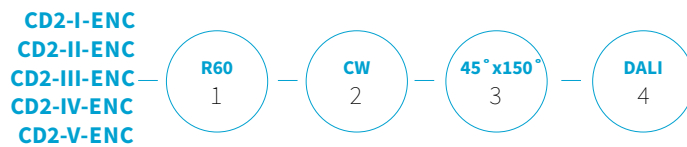

Size	I	II	III	IV	V	
1 Model	R60 Pole mounting		R76 Pole mounting			
2 Colour temp.	WW 3000K		NW 4000K	CW 5700K		
3 Optics	30°x120° Beam angle		45°x150° Beam angle		70°x120° Beam angle	PD Pedestrian Crossing
4 Control	DALI	Nema socket	Virtual Extension	PLC	DIM 1-10V	